

Kronobuild®

# P5 & OSB3 T&G Flooring

## Fitting Recommendations

Kronobuild® P5 T&G Flooring is available in two thicknesses, 18 and 22mm.

Kronobuild® OSB 3 T&G is available in 18mm.

Use Kronobuild® T&G Flooring P5 18mm for domestic applications with a maximum joist/batten spacing up to 450mm centres, 22mm for joist/batten spacings up to 600mm. (Restricted to uniformly distributed load of 1.5kN/m<sup>2</sup>).

Use Kronobuild® P5 22mm for domestic and non-domestic applications i.e. offices, schools on joist/batten spacings up to 400mm centres. (Restricted to uniformly distributed load of 2.5kN/m<sup>2</sup> and concentrated load of 2.7kN).

Use Kronobuild® OSB 3 T&G in domestic applications with a joist / batten spacing of 600mm.

OSB boards must always be laid so that the higher strength of boards (main axis, the longitudinal direction boards) is in the direction perpendicular to the joists.



### 01. STORAGE

Following delivery, boards should be stored in a dry/covered building on a flat floor.

Conditioning of the boards should take place in the area and atmospheric conditions in which they will be installed. Allow 2-3 days for conditioning.

Store boards with spacers to allow free air movement to both faces. Store on level bearers to preserve board flatness.

### 02. PRE-INSTALLATION CHECKS

Always ensure that the building is weathertight before installing the floor i.e. roof on and windows and doors fitted, this is a NHBC requirement.

Plan carefully for all pipes and other services and provide full support on all sides as shown below (Please see diagram A).

Kronobuild® P5 T&G Flooring must be installed with the black ink marking on the underside. Ensure the joints match together securely.

Remember to protect your Kronobuild® T&G Flooring boards before, during and after installation.

### 03. MOVEMENT & EXPANSION

These guidelines apply to both joisted and floating floors.

Allow a clear movement gap of 2mm per metre run of floor at each wall and an absolute minimum gap of 12mm at each wall. Gaps should be left around rigid upstands including pipes (see diagram B).

For floors where the movement gap cannot be dealt with at the perimeter alone or which are in excess of 6 meters long. e.g. corridors, intermediate expansion gaps (minimum 12mm), should be incorporated. Expansion gaps can be hidden at door thresholds (see diagram C).

Do not allow the movement gap to be obstructed with debris and maintain perimeter gaps using packers or wedges. Remove immediately after adhesive has set.

Protect the floor from wet trades and any water spillage at all times. In areas with higher than average temperatures. e.g. nursing homes, hospitals, etc. it is vital that careful attention is given to conditioning. Ensure heating is increased gradually. There is a greater risk of board shrinkage so movement provision may have to be adjusted accordingly.

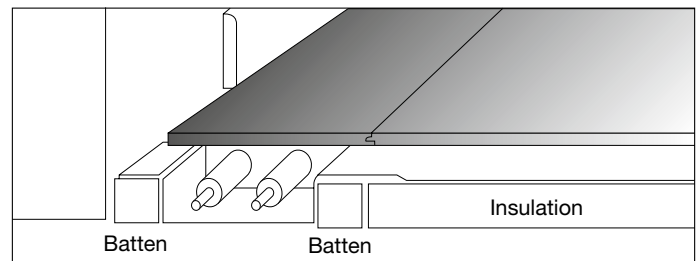

A. Correct fitting of Kronobuild® T&G Flooring over pipes and services.

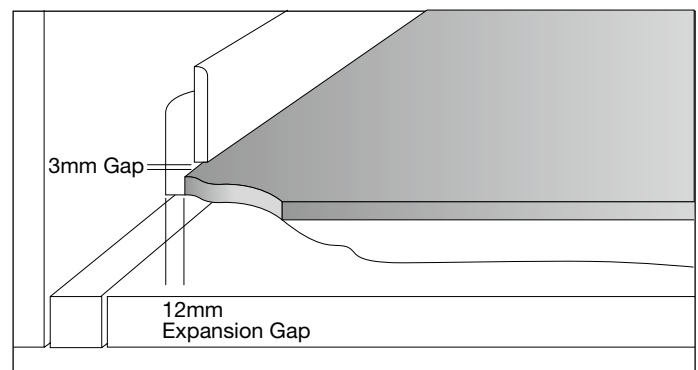

B. Expansion gap requirements

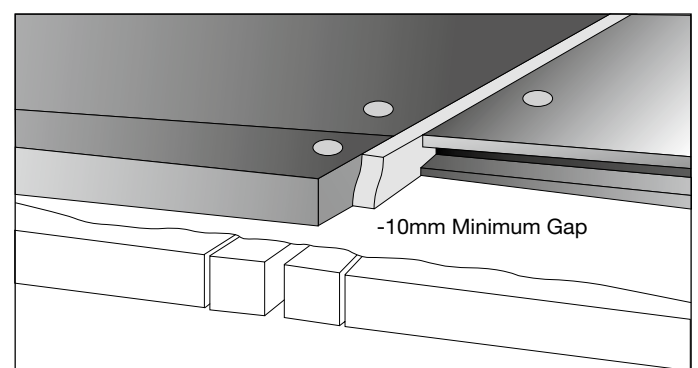

C. Intermediate expansion gap

## 04. CONSTRUCTION OF FLOATING FLOOR

Kronobuild® OSB 3 T&G is not recommended for floating floors.

Kronobuild® P5 T&G Flooring can be used on floating floors and battened floating floors.

All ground supported concrete floor slabs must have a level surface similar to that produced by a float finish.

A layer of suitable insulation material must be placed onto the floor slab with consideration given to loading, thermal and acoustic requirements. The insulation must be continuous and should be laid so that the joints do not coincide with those of the Kronobuild® P5 T&G Flooring.

A moisture and vapour control layer (VCL) providing a minimum vapour resistance of 250MNs/g must be laid above the insulation layer and should be upturned by 38mm around the perimeter walls. 250 micron (1000 gauge) polythene sheet will provide the minimum requirement. Any joints in the sheet should be overlapped by 150mm and taped with vapour resistant tape (see diagram D). The boards should be laid in a brick bond fashion, with staggered short end joints and should not coincide with joints in insulation.

Load bearing partitions must not be built on top of Kronobuild® P5 T&G Flooring but should be continuously supported from beneath.

Non load bearing partitions not exceeding 81.5kg/metre (0.8kN/M) can be built directly on top of Kronobuild® P5 T&G Flooring. As an alternative, in areas where more stability and additional loading is required, treated timber battens can be incorporated into the construction of the floor.

## 05. JOISTED FLOORS

Joists should be installed as recommended in BS5268 (see diagram E).

In battened/joisted floors the boards are laid with the long edge across the supporting batten/joist. Short joints should be staggered and supported along the centre line of a batten/joist.

Where joints do not coincide with a joist, they must be supported by a separate noggin, in accordance with NHBC requirements.

All joints must be glued with a suitable adhesive, which should be liberally applied to coat both surfaces of the tongue. Gluing will strengthen the joint and reduce the risk of squeaking. PVAC adhesive to durability class D3 of BS EN 204:1991 is recommended.

Only flat headed annular ringshank, or other improved nails with superior holding power and corrosion resistance should be used. Four nails at equidistant centres should be used on each short joint, 25mm from short edge. Minimum nail length should be 2.5 times the board thickness and the minimum diameter should be 3mm.

All nail heads should be punched home. Using No.8 Particleboard screws, the minimum screw length should be 2.5 times the board thickness or 50mm whichever is greater.

## 06. FINISHING

Vinyl flooring or carpet may allow the board / joints to telegraph through and will tend to show small irregularities in a floor's surface. Where necessary, it is acceptable to sand off any raised joints before covering the floor.

Where vinyl coverings are used, a thin wood based panel overlay e.g. 4mm plywood, should be fixed in position, staggering joints so as not to coincide with those of the T&G Flooring.

The fixing of ceramic tiles to a floating floor, is not recommended.

### Construction of Floating Floor

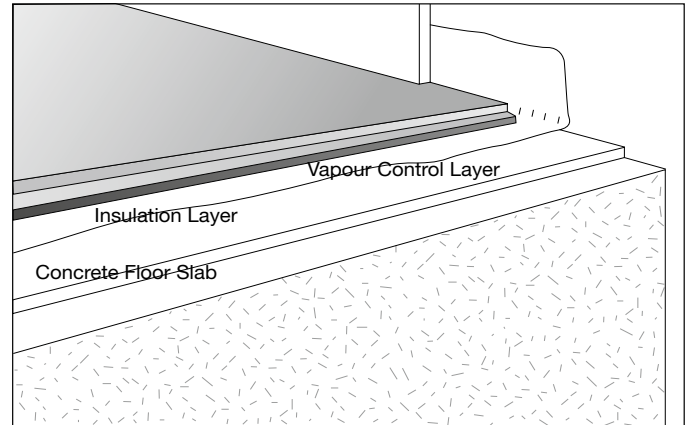

D. Diagram of correct fitting of Kronobuild® P5 T&G Flooring to floating floor

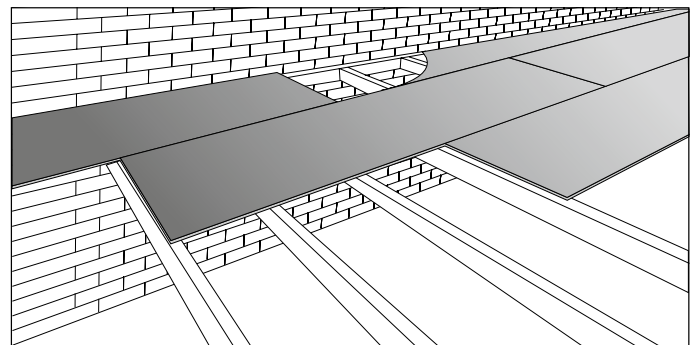

E. Kronobuild® P5 T&G Flooring installed on joists

## GENERAL PROPERTIES

Please refer to the DoPs on our website:  
[uk.kronospan-express.com/en/express-services/downloads](http://uk.kronospan-express.com/en/express-services/downloads)

## KRONOBUILD® T&G FLOORING HELPLINE

If you have any further questions about Kronobuild® T&G Flooring or encounter problems during installation, call our Customer Services Department on: 01691 775 229.

